

BAYLAN

WATER METERS

TK-29

Multi jet Dry type Water Meter



GENERAL

- MID Certified
- Suitable for potable water • 359° rotating dial
- Multi jet working principle assures a long service time
- Low pressure loss, high sensitivity at initial flow
- Vacuumed mechanism
- Special glass against for impact and pressure
- Electrostatic painted body made of corrosion resistant brass
- For optical reading • Non return valve
- AMR reading features are optional
- 3 years of warranty • Almost no maintenance
- Suitable for cold water up to 50°C
- Service and spare parts available for 10 years

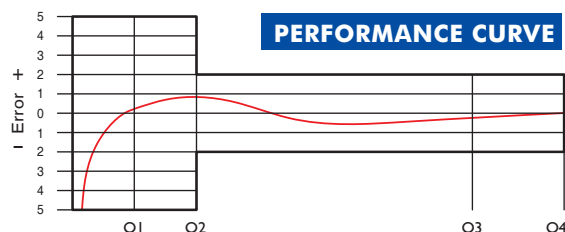

PERFORMANCE DATA

Nominal diameter	DN	15 / 20				20					
Overload Flowrate	Q4	m ³ /h 3.125				5.000					
Permanent Flowrate	Q3	m ³ /h 2.5				4					
Transitional Flowrate	Q2	m ³ /h	0.040	0.032	0.025	0.100	0.064	0.051	0.04	0.16	
Minimum Flowrate	Q1	m ³ /h	0.025	0.020	0.0156	0.0625	0.040	0.032	0.025	0.1	
Q3/Q1 (MI-001 OIML R49)	-		100	125	160	40	100	125	160	40	
Mounting on the network	-	H		V		H		V			
Maximum Registration Capacity	m ³	9999 / 99999 / 99999,99 / 99999,999									
Initial Flow	Qi	l/h	4								
Maximum Working Pressure	bar	16									
Maximum Working Temperature	°C	50									
Pressure Loss	bar	0.6									
Smallest Reading Resolution	m ³	0.00005									
Class	-	Class 1/Class 2									
Quantity per package	-	10									

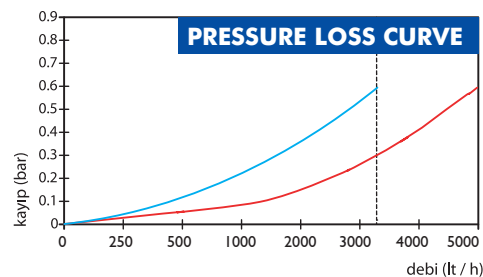
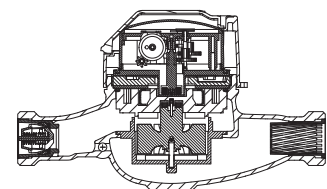

DIMENSIONS

Nominal diameter	DN	15	20	mm
Connecting diameter	D	G 3/4	G 1	B
Total overall meter height	H	110,5	110	mm
Axis height	h	32	33	mm
Length	L	165 190	190	mm
Length with connections	LB	245 270	270	mm
Width	B	84	85	mm
Unit weight		1,07	1,00	kg
Package Weight (without connect)		11,51	10,76	kg
Package Weight (with connect)		13,00	12,56	kg
Package dimensions		27x48,5x20	27x48,5x20	cm

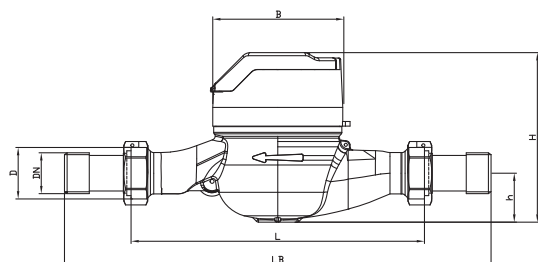

"Due to continuous development of our products, we reserve the right to modify our product design or construction without prior notice."